



MOVE INN ESTATES

MAKING THE RIGHT MOVE



Coronation Road

, Hayes, UB3 4JU

Price Guide £450,000



2 1 1 D



Floor Plan

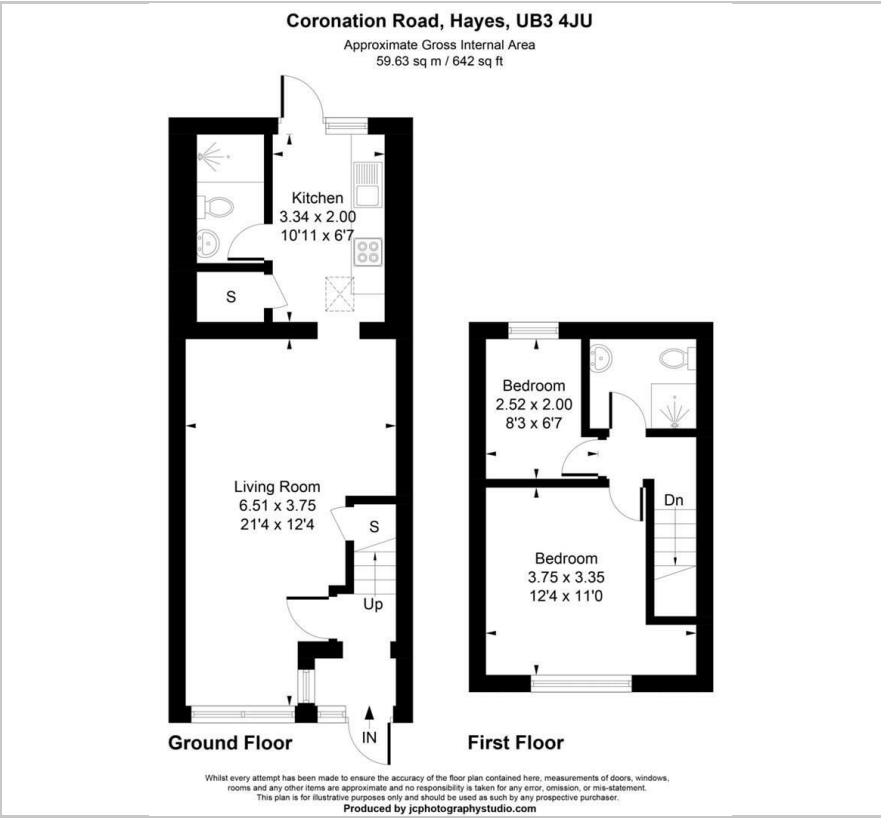

Area Map



Energy Efficiency Graph

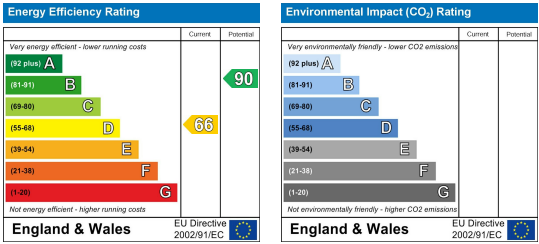

Viewing

Please contact our Move Inn Estates - Sales Office on 0208 574 4966 if you wish to arrange a viewing appointment for this property or require further information.

- Three Bedrooms
- Off-Street Parking
- Gas Central Heating
- Chain Free
- Mid-Terrace Home
- Rear Garden
- Double Glazing
- Freehold



Charming Three-Bedroom Mid-Terrace Home in South Hayes

Perfectly positioned within easy reach of Hayes & Harlington Station and excellent transport links, this freehold three-bedroom family home offers fantastic potential for modernisation and extension (STPP).

The property features a spacious family lounge, a fitted kitchen, and a family bathroom, providing a practical layout ideal for family living. Outside, you'll find a generous rear garden—a great space for entertaining or expanding the property further—and off-street parking at the front for added convenience.

Additional benefits include gas central heating, double-glazed windows, and close proximity to local schools, shops, and amenities.

Whether you're a first-time buyer, growing family, or investor, this home presents an exciting opportunity to create your perfect space in a well-connected location.

Viewings highly recommended — don't miss out!



These particulars, whilst believed to be accurate are set out as a general outline only for guidance and do not constitute any part of an offer or contract. Intending purchasers should not rely on them as statements of representation of fact, but must satisfy themselves by inspection or otherwise as to their accuracy. No person in this firms employment has the authority to make or give any representation or warranty in respect of the property.